

M-SERIES CRUISING MOTORYACHTS

Maritimo[®]
OCEANS APART





LUXURY AND PERFORMANCE IN PERFECT HARMONY

Built in Australia by the finest craftsman, Maritimo blends its race honed performance pedigree with Australia's easy living approach to create luxury boating with rugged blue water credentials.

We are dedicated to crafting distinctive high quality motoryachts that are thoughtfully laid out and luxuriously finished. Each offers its owner timeless elegance and unparalleled abilities in the water.

Maritimo®

OCEANS APART

DESIGN THAT ENSURES SIMPLICITY, EFFICIENCY AND CRUISABILITY

Underneath the hand crafted wood, fine leather and clever ergonomics, you'll find the best in nautical design that ensures simplicity, efficiency and cruisability.

We take a fresh approach to luxury, creating beautifully finished generous apartment-like interior spaces ideal for both relaxed on-board family living and more formal entertaining.

When it's time for deep-water action you'll find Maritimo's racing edge more than meets the demands of the sports fisherman and high performance island-hopping adventure.

INTERNAL STAIRCASE

Stylish finely crafted timber and stainless steel internal staircases keep everyone safe and dry in rough weather.

FULL BEAM MASTER CABIN

Every Maritimo M-Series motoryacht provides a full beam master cabin with king or queen size bed, ensuite and chaise lounge.





AFT GALLEY

Whether you're entertaining in the cockpit or saloon the chef remains part of the conversation with Maritimo's aft galley arrangement and wide opening bi-fold doors. Fitout with Miele appliances including a full stand up dishwasher, speed oven cook top with range hood, and refrigerator with in-built ice maker.



BI-FOLD DOORS

Unique bi-fold doors open up the whole living space into one large entertaining area. Entertaining is a breeze with the galley as the centre of the action and the island bench doubling as a cocktail bar. For those cooler days or to access the cockpit while running, you only need open one port side door.



WALK AROUND DECKS

The walk around side decks of a Maritimo allow safe and easy access to the foredeck, perfect for children and pets. Whether you're pulling up a mooring or dropping anchor, tying up at a wharf, getting the lines and fenders ready, or for those who like to wet a line, you'll wonder how you ever managed without them.



EASY HANDLING AND BERTHING

Maritimo's ergonomic dashboards feature the latest large screen electronics and intuitively configured controls for easy handling. They can be fitted with optional docking thrusters to aid berthing and vessel control in tight confined canal type waterways or crowded marinas. Key engine controls are also replicated in the aft cockpit for simpler docking.



EFFICIENT RACE BRED SHAFT DRIVE

Smart, innovative, practical design lies at the heart of the Maritimo philosophy. Big ideas - like a low angle race bred shaft drive and our super strong hand laid hull with patented bonding technology ensures best in class efficiency and excellent sea going abilities. Attention to detail - like perfectly located fuel gauges and creating a simple concise electrical panel layout that makes everyday boat management and long distance performance cruising straightforward and safe.



FULLY ENCLOSED FOUR SIDED FLYBRIDGE

More than an upper bridge, Maritimo's trademark enclosed flybridge gives an extra level of relaxed sophistication, space and luxury.







M70

OUR FLAGSHIP THAT PUTS THE OCEANS AT YOUR COMMAND

Our blue water flagship takes oceans in its stride, combining supreme performance and smart, timeless luxury in a four-cabin, eight-berth motoryacht with a potential high speed cruising range of up to 700 nautical miles.

This is a serious luxury motoryacht. Fitted with twin 900 MHP (Volvo) engines as standard, you can island hop with ease maintaining average speeds of 21 knots or more over vast distances.



Maritimo's race bred shaft drive and hull design ensure the best fuel consumption in its class giving the M70 the ability to travel over 1020km (700 miles) between fuel stops. You may also opt for extra power with twin 1200 HP engines.

While it makes big strides, it's the small details that will impress during long stays on board. Luxurious finishes include a full beam ensuite and split-level master stateroom with a king size bed and the option of double domestic sized fridges in the beautifully appointed galley.

Outside, enjoy the wide walk around decks and bi-fold doors that double the size of your "at anchor" or "cruising" living areas. The smart use of space flows inside with a fully configured aft galley featuring Miele appliances. An internal staircase leading up to the fully enclosed saloon sized flybridge - effectively gives you an apartment-like two storey entertaining and living area.







Customise your luxury island home with a range of options including convertible berths, relocatable tables, a wet bar and two transom configurations - euro style or sports fishing. The choice is yours.

M70 SPECIFICATIONS

LENGTH OVERALL	21.51 M	70' 7" FT
HULL LENGTH ISO	21.215 M	69' 7" FT
BEAM	5.67 M	18' 8" FT
DRAFT	1.5 M	4' 11" FT
DRY WEIGHT	43,000 KG	94,800 LBS
FUEL CAPACITY	6,300 L	1,664 US GAL
WATER CAPACITY	1,400 L	370 US GAL
HOLDING TANK CAPACITY	400 L	105 US GAL
SLEEPING CABINS	4	
SLEEPING CAPACITY	8 STANDARD	
ENGINES (STANDARD)	2 x VOLVO D13 - 900 MHP	
GENERATOR	CUMMINS - ONAN 27.5 kW	







M64

OUR FLAGSHIP MOTORYACHT IN A MORE COMPACT HULL

The Maritimo M64 cruising motoryacht is effectively our 'mini' M70, though at sixty-four feet this is a highly impressive boat. Its shorter length simply means you no longer need to compromise on luxury and long-range performance if you have tighter berthing requirements.

The M64 is the perfect example of where innovative engineering and design efficiency combine to deliver the ultimate performer.



In line with Maritimo's grand design ambitions, the on board living is 'large'. Enjoy the same feeling of apartment sized interior space found in the M70, with a full beam master suite including king size bed and generous ensuite, fully enclosed flybridge, walk around decks, bi-fold doors and enclosed stairway between the bridge and lounge. The M64 provides spacious dual level luxury and numerous entertaining options for the ultimate in relaxed easy going yachting.

Powered by a pair of Volvo D13 900 MHP engines, it places 1800 MHP at your disposal whilst Maritimo's race proven shaft drive and hull design technology ensures superior fuel consumption for long range high speed blue water cruising.

A range of flexible configurations are offered to suit your requirements. Choose a three cabin, three bathroom configuration - ideal for giving teenage children or guests their own space - or four cabins and two bathrooms. Outside, choose from either our popular euro style or sports fishing transoms.







In keeping with all Maritimo motoryachts, your personal taste can be accommodated into the finished layout including a choice of hand crafted timber detailing, convertible berths, relocatable tables and a wet bar.

M64 SPECIFICATIONS

LENGTH OVERALL	19.51 M	64' FT
HULL LENGTH ISO	19.11 M	62' 9" FT
BEAM	5.67 M	18' 8" FT
DRAFT	1.415 M	4' 8" FT
DRY WEIGHT	39,000 KG	86,000 LBS
FUEL CAPACITY	5,600 L	1,479 US GAL
WATER CAPACITY	750 L	198 US GAL
HOLDING TANK CAPACITY	300 L	79 US GAL
SLEEPING CABINS	3 STANDARD	4 OPTIONAL
SLEEPING CAPACITY	6 STANDARD	8 OPTIONAL
ENGINES (STANDARD)	2 x VOLVO D13 - 900 MHP	
GENERATOR	CUMMINS - ONAN 21.5 KW	

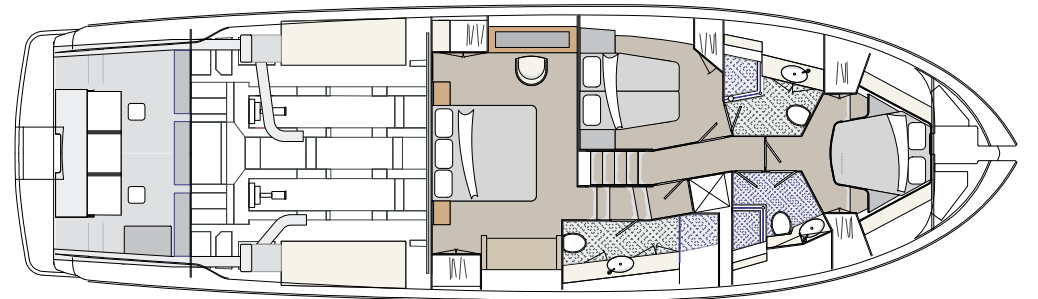
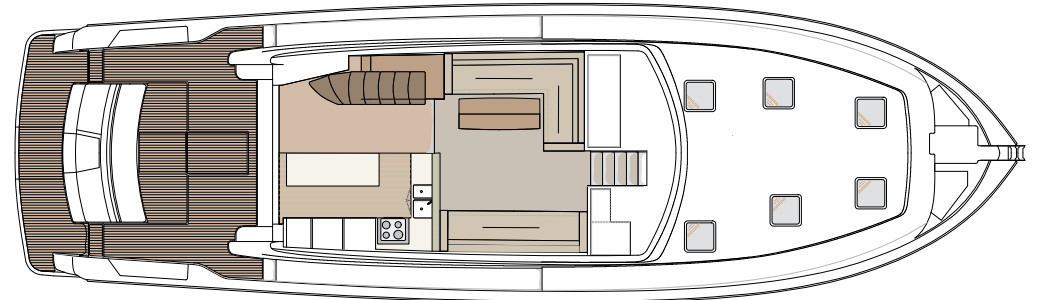
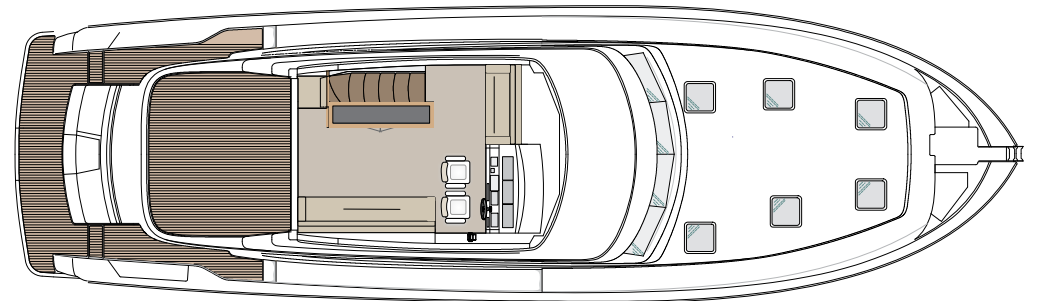





M62

POWER AND PLAY IN PERFECT BALANCE

The M62 is arguably Maritimo's finest hour. Where clever interior design, hand crafted luxury finishes and race proven performance blend perfectly to set not just a new benchmark for luxury motor cruising, but the standard by which we measure our own craft.

A motoryacht that gives you the luxury and apartment like interior space of our larger models within a narrower beam, creating a supremely accomplished ocean going vessel where your every comfort is beautifully accommodated.



The M62 is the family "home away from home", timeless elegant, yet smart and modern with a full beam master stateroom featuring a king size bed, ensuite, chaise lounge and make up vanity or study. Together with a beautifully appointed aft galley equipped with Miele appliances and capacious pantry, you'll want for nothing during long stays aboard.

Aft bi-fold doors enhance the spacious apartment feel and an internal staircase leads to the fully enclosed flybridge, complete with second saloon, extended aft balcony and sunroof. This area can also double as an optional second stateroom with the option of the dinette converting to a large double berth.

Powered by twin Volvo 800 MHP engines the M62's design and engineering excellence delivers exceptional sea keeping ability, sleek lines and fail safe electrical systems. You will enjoy unrivalled running performance from her hand-laid dynamic variable dead rise hull, race proven shaft drive technology and low shaft angle.

Whether you're looking for the ideal sport fishing boat or the perfect luxury entertainer, the M62 always delivers an exceptional boating experience.







Like all Maritimo motoryachts, the M62 comes with a five-year structural warranty ensuring thousands of hours of efficient, reliable running.

M62 SPECIFICATIONS

LENGTH OVERALL	19.16 M	62' 11" FT
HULL LENGTH ISO	18.84 M	61' 10" FT
BEAM	5.29 M	17' 4" FT
DRAFT	1.44 M	4' 9" FT
DRY WEIGHT	29,000 KG	63,934 LBS
FUEL CAPACITY	4,400 L	1,160 US GAL
WATER CAPACITY	800 L	211 US GAL
HOLDING TANK CAPACITY	300 L	79 US GAL
SLEEPING CABINS	3	OPTIONAL 4
SLEEPING CAPACITY	6 STANDARD	
ENGINES (STANDARD)	2 x VOLVO D13 - 800 MHP	
GENERATOR	CUMMINS - ONAN 21.5 kW	



M59

NEW FOR 2017



M59 SPECIFICATIONS

LENGTH OVERALL	17.98 M	59' FT
HULL LENGTH ISO	17.68 M	58' FT
BEAM	5.46 M	17' 11" FT
DRAFT	1.225 M	4' FT
DRY WEIGHT	27,000 KG	59,500 LBS
FUEL CAPACITY	4,400 L	1,162 US GAL
WATER CAPACITY	700 L	185 US GAL
HOLDING TANK CAPACITY	300 L	80 US GAL
SLEEPING CABINS	3	
SLEEPING CAPACITY	6 STANDARD	OPTIONAL 8
ENGINES (STANDARD)	2 x VOLVO D11 - 725 MHP	
GENERATOR	CUMMINS - ONAN 21.5 KW	

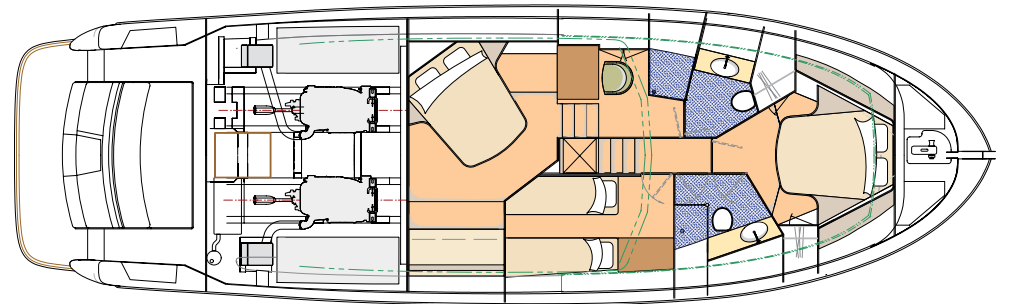
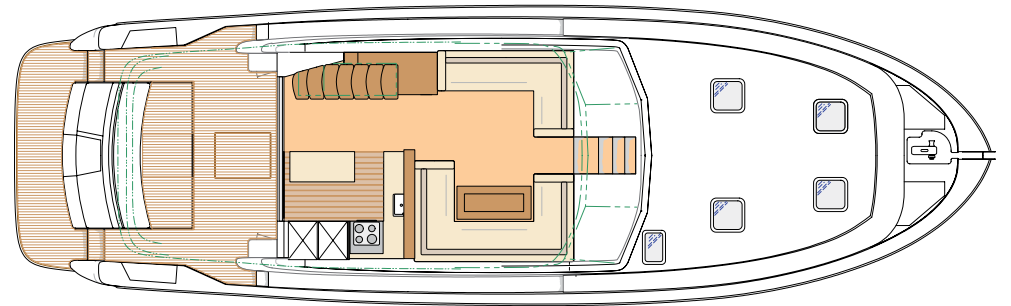
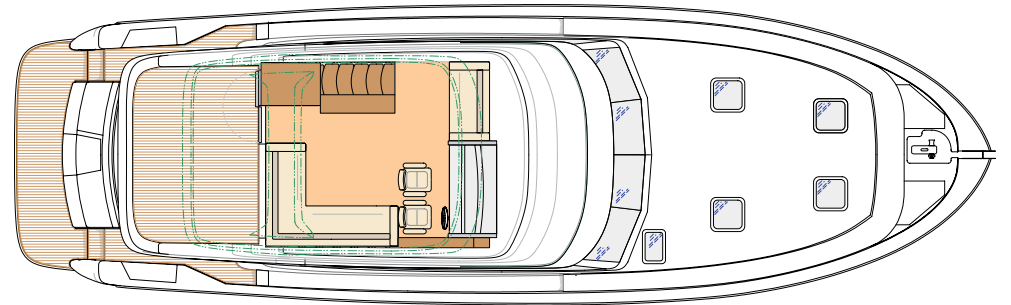





M54

THE MOTORYACHT THAT REDEFINES LUXURY MOTOR CRUISING.

Few, if any, boat builders can offer you a highly efficient straight shaft drive and a full beam master cabin in a 54 footer. That's why we've labelled the M54 as the boat that marries luxury and play without compromising either.

Enjoy the same hand crafted luxury apartment style feel that you find in our larger flagship models, but for a lower outlay.

Maritimo “design smarts” prove there’s no need to compromise. The M54 offers plenty of room to relax in style incorporating a full beam master with ensuite, featuring a mezzanine level with lockers, drawers, full-length mirror and vanity.

All the Maritimo hallmarks are aboard - fully enclosed air conditioned flybridge, wide walk around decks, enlarged cockpit with bi-fold doors, aft galley design with full-size fridge, well-appointed pantry and top quality Miele appliances.

When you're not relaxing, entertain your guests with the M54's sea going prowess. Our low angle straight drive delivers a very comfortable cruise attitude for long range fuel efficiency and a motoryacht that handles rough seas with remarkable assurity.







Maritimo marks a bold evolution in long range motoryacht design, adopting a dynamic profile across its M-Series range with a powerful and stylish stance. The M54 is no exception

M54 SPECIFICATIONS

LENGTH OVERALL	16.505 M	54' 2" FT
HULL LENGTH ISO	16.275 M	53' 5" FT
BEAM	5.08 M	16' 8" FT
DRAFT	1.225 M	4' FT
DRY WEIGHT	22,000 KG	48,500 LBS
FUEL CAPACITY	3,800 L	1,003 US GAL
WATER CAPACITY	800 L	211 US GAL
HOLDING TANK CAPACITY	300 L	79 US GAL
SLEEPING CABINS	3	
SLEEPING CAPACITY	6 STANDARD	
ENGINES (STANDARD)	2 x VOLVO D11 - 670 MHP	
GENERATOR	CUMMINS - ONAN 21.5 KW	

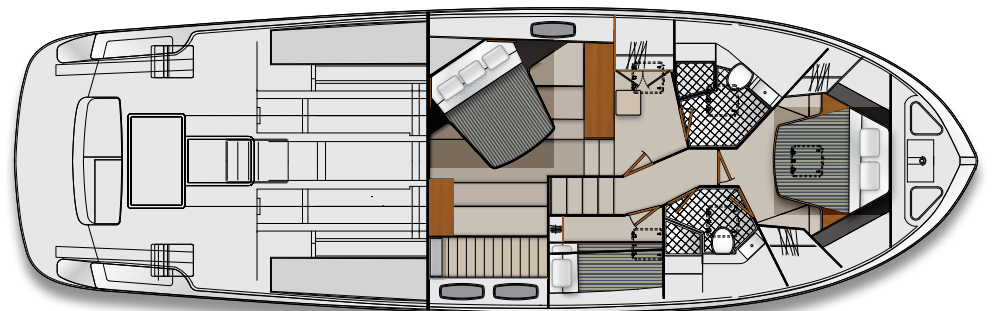
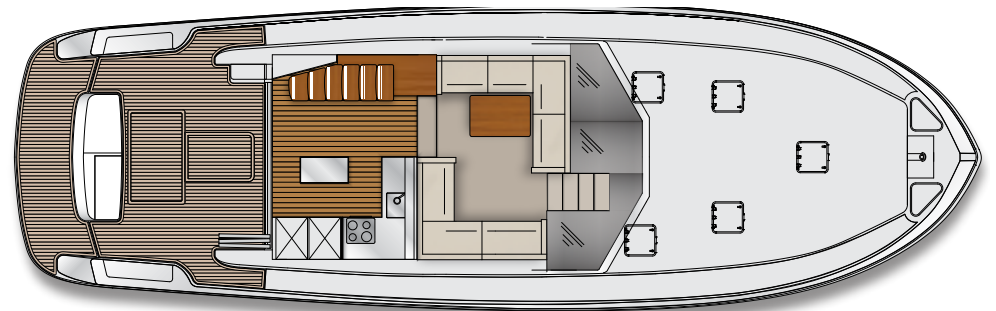
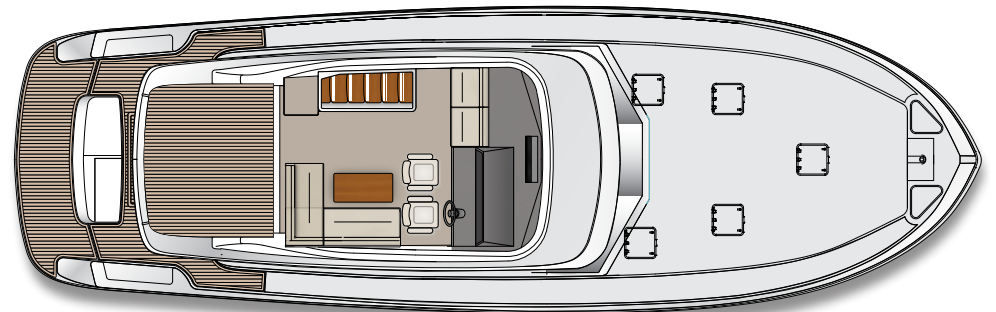





M51

THE COMPACT HIGH ACHIEVER

Our most compact flybridge motor cruiser, the Maritimo M51 demonstrates what can and should be done when you enter the world of luxury high performance motoryachts. We started with a clean sheet of paper, a keen sense of contemporary style and a maritime engineering pedigree honed from producing 175 kph offshore race boats to create this stunning motoryacht.

Maritimo's hull design and race-bred direct shaft drive create a boat with superb balance, poise and fuel efficiency. A unique design approach which results in a rugged yet easy to handle 1340 horsepower powerhouse perfectly equipped to indulge your family and guests in remarkable amounts of space and luxury.



Setting a new standard, the M51 features a stylish internal staircase leading to an enclosed flybridge, which can double as an upstairs living area with an optional fold out sofa. Featuring an impressive full beam master cabin and an innovative third cabin to starboard which you can option as a utility room.

Simple ideas that are often overlooked make all the difference. These Maritimo hallmarks include safe, wide, walk around decks for easy berthing and aft bi-fold doors to the rear cockpit, which together with a generously proportioned aft galley, amplify your living space and make relaxation a breeze.

In fact innovative use of space is the biggest Maritimo luxury of all. Ideas like the standard electrically operated lazarette hatch in the cockpit to ensure every area within the M51 is placed to good use.







Maritimo offers you flexibility and choice for any adventure including optional fishing transom with large freezer, under floor fish bins and live bait tanks.

M51 SPECIFICATIONS

LENGTH OVERALL	16.19 M	53' 1" FT
HULL LENGTH ISO	15.93 M	52' 3" FT
BEAM	5.06 M	16' 7" FT
DRAFT	1.30 M	4' 3" FT
DRY WEIGHT	21,000 KG	46,300 LBS
FUEL CAPACITY	3,100 L	818 US GAL
WATER CAPACITY	500 L	132 US GAL
HOLDING TANK CAPACITY	300 L	79 US GAL
SLEEPING CABINS	3	
SLEEPING CAPACITY	5 STANDARD	7 OPTIONAL
ENGINES (STANDARD)	2 x VOLVO D11 - 670 MHP	
GENERATOR	CUMMINS - ONAN 13.5 kW	





THE CHOICE IS YOURS

The Maritimo M-Series offers you a range of great options and flexibility to personalise your motoryacht.

Maritimo make it easy through a logical series of steps to make your motoryacht a true expression of your individuality. You have a number of choices: from selecting your engines to exterior and interior colours, finishes and those detailed touches that define your character.



1

STEP 1 CHOOSE YOUR MODEL

Compare the standard features of each M-Series model and choose the one that best suits your lifestyle.

2

STEP 2 CHOOSE YOUR ENGINE

Most models offer a choice of powerful engines.

3

STEP 3 CHOOSE YOUR COLOUR

There's a wide range of possibilities for your hull colour to individualise your vessel.

4

STEP 4 CHOOSE YOUR INTERIOR

Personalise your own interior space from a carefully selected range of finishes and furnishings.

5

STEP 5 CHOOSE YOUR ACCESSORIES

Enhance your Maritimo further from our range of genuine accessories.

M-SERIES COMPARISON

M70

LENGTH OVERALL	21.51 M	70' 7" FT
HULL LENGTH ISO	21.215 M	69' 7" FT
BEAM	5.67 M	18' 8" FT
DRAFT	1.5 M	4' 11" FT
DRY WEIGHT	43,000 KG	94,800 LBS
FUEL CAPACITY	6,300 L	1,664 US GAL
WATER CAPACITY	1,400 L	370 US GAL
HOLDING TANK CAPACITY	400 L	105 US GAL
SLEEPING CABINS	4	
SLEEPING CAPACITY	8	
ENGINES (STANDARD)	2 x VOLVO D13 - 900 MHP	
GENERATOR	CUMMINS - ONAN 27.5 kW	

M64

LENGTH OVERALL	19.51 M	64' FT
HULL LENGTH ISO	19.11 M	62' 9" FT
BEAM	5.67 M	18' 8" FT
DRAFT	1.415 M	4' 8" FT
DRY WEIGHT	39,000 KG	86,000 LBS
FUEL CAPACITY	5,600 L	1,479 US GAL
WATER CAPACITY	750 L	198 US GAL
HOLDING TANK CAPACITY	300 L	79 US GAL
SLEEPING CABINS	3	4 OPTIONAL
SLEEPING CAPACITY	6	8 OPTIONAL
ENGINES (STANDARD)	2 x VOLVO D13 - 900 MHP	
GENERATOR	CUMMINS - ONAN 21.5 kW	

M62

LENGTH OVERALL	19.16 M	62' 11" FT
HULL LENGTH ISO	18.84 M	61' 10" FT
BEAM	5.29 M	17' 4" FT
DRAFT	1.44 M	4' 9" FT
DRY WEIGHT	29,000 KG	63,934 LBS
FUEL CAPACITY	4,400 L	1,160 US GAL
WATER CAPACITY	800 L	211 US GAL
HOLDING TANK CAPACITY	300 L	79 US GAL
SLEEPING CABINS	3	4 OPTIONAL
SLEEPING CAPACITY	6	
ENGINES (STANDARD)	2 x VOLVO D13 - 800 MHP	
GENERATOR	CUMMINS - ONAN 21.5 kW	

M59

LENGTH OVERALL	17.98 M	59' FT
HULL LENGTH ISO	17.68 M	58' FT
BEAM	5.46 M	17' 11" FT
DRAFT	1.225 M	4' FT
DRY WEIGHT	27,000 KG	59,500 LBS
FUEL CAPACITY	4,400 L	1,162 US GAL
WATER CAPACITY	700 L	185 US GAL
HOLDING TANK CAPACITY	300 L	80 US GAL
SLEEPING CABINS	3	
SLEEPING CAPACITY	6	8 OPTIONAL
ENGINES (STANDARD)	2 x VOLVO D11 - 725 MHP	
GENERATOR	CUMMINS - ONAN 21.5 kW	

M54

16.505 M 54' 2" FT

16.275 M 53' 5" FT

5.08 M 16' 8" FT

1.225 M 4' FT

22,000 KG 48,500 LBS

3,800 L 1,003 US GAL

800 L 211 US GAL

300 L 79 US GAL

3

6

2 x VOLVO D11 - 670 MHP

CUMMINS - ONAN 21.5 kW

M51

16.19 M 53' 1" FT

15.93 M 52' 3" FT

5.06 M 16' 7" FT

1.30 M 4' 3" FT

21,000 KG 46,300 LBS

3,100 L 818 US GAL

500 L 132 US GAL

300 L 79 US GAL

3

5 7 OPTIONAL

2 x VOLVO D11 - 670 MHP

CUMMINS - ONAN 13.5 kW



RACING GENES

With a heritage in offshore racing, Maritimo provides world-class technology that excites all true boating enthusiasts with no compromise on luxury.

At 175mph, there is no such thing as over engineering. Intelligent weight distribution, light weight durable materials, precision components and full power steering creates smooth, exact and responsive performance.

Maritimo has been at the leading edge of offshore racing both in Australia and internationally and with these credentials, no other manufacturer can match the technology and performance built into every Maritimo.





Martimo

LONG RANGE LUXURY MOTOR YACHTS

WS326Q

11

AUSTRALIA

THE WORLD OF MARITIMO



MARITIMO MUSTERS

As a proud Maritimo owner, become part of our story at one of our Maritimo Musters held around the world. Meet new friends, speak to our team about how each and every model is built, while your driving skills are put to the test.



GLOBAL BOAT SHOWS

Experiencing a Maritimo has never been easier with our dedication to an international boat show schedule across Australia, the Americas and Europe. This is an opportunity for you to be informed and entertained on Maritimo's latest models. Visit our website and social channels to find a boat show near you. maritimo.com.au



MARITIMO VIP EVENTS

The benefits of owning a Maritimo extend beyond the pleasurable days out on the water. You become part of our family which provides a range of exclusive benefits for you to enjoy. From special VIP events across the world, the chance to be part of product development and 'experience days' with our brand partners, there's plenty to be involved in.



CONNECT WITH MARITIMO

Maritimo's digital world offers you the opportunity to connect with us. Our website, Facebook, Instagram, Twitter, LinkedIn and YouTube channels are filled with the latest Maritimo news, events and models, plus insights into the factory and offshore racing.



MARITIMO COLLECTION

Your motoryacht is just the beginning. The latest Maritimo Collection is now available for you to discover.

Meticulous attention to detail doesn't stop with our motoryachts. You'll find the same level of craftsmanship in our clothing. Partnering with Henri Lloyd, we have produced a range of premium clothing that is not only stylish but practical. So whether you're shopping for yourself or a loved one, you know the quality is assured.

The Maritimo Collection includes ladies and gents clothing as well as a range of bags and accessories. Visit our online shop at shop.maritimo.com.au.

DISCLAIMER

IMPORTANT NOTICE

Maritimo Offshore Pty Ltd is constantly seeking ways to improve the specifications, designs and production of its motoryachts and enhancements take place continually. Whilst every effort is made to ensure up to date literature, this brochure should not be regarded as an infallible guide to current specifications.

Always check with your authorised Maritimo consultant to ensure you have the latest specifications, options and pricing. We reserve the right to change specifications, fittings, inventory and prices without notice.

© Copyright 2016 Maritimo Offshore Pty Ltd

Maritimo[®]

OCEANS APART

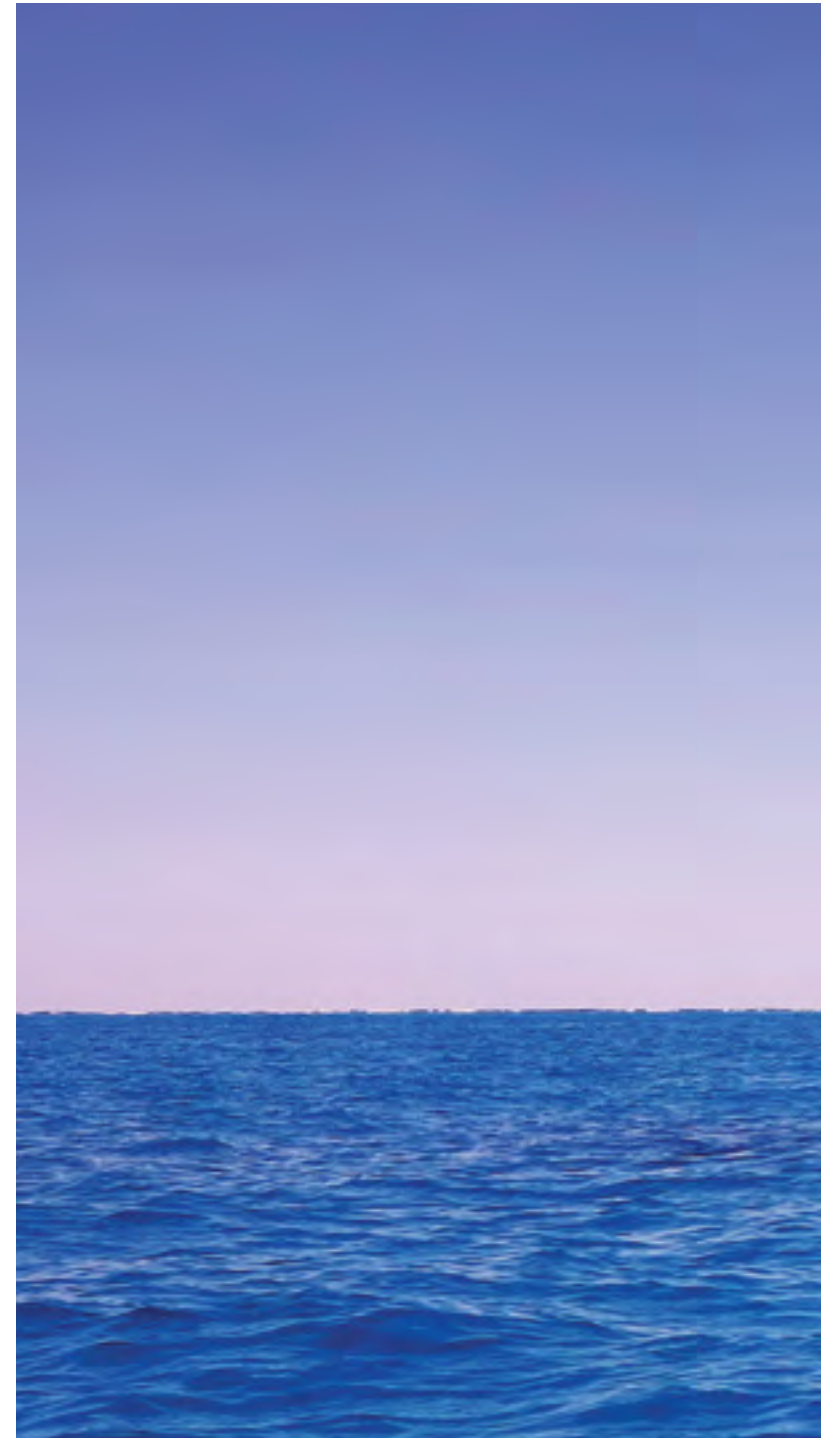



MARITIMO.COM.AU

Maritimo[®]
OCEANS APART

